

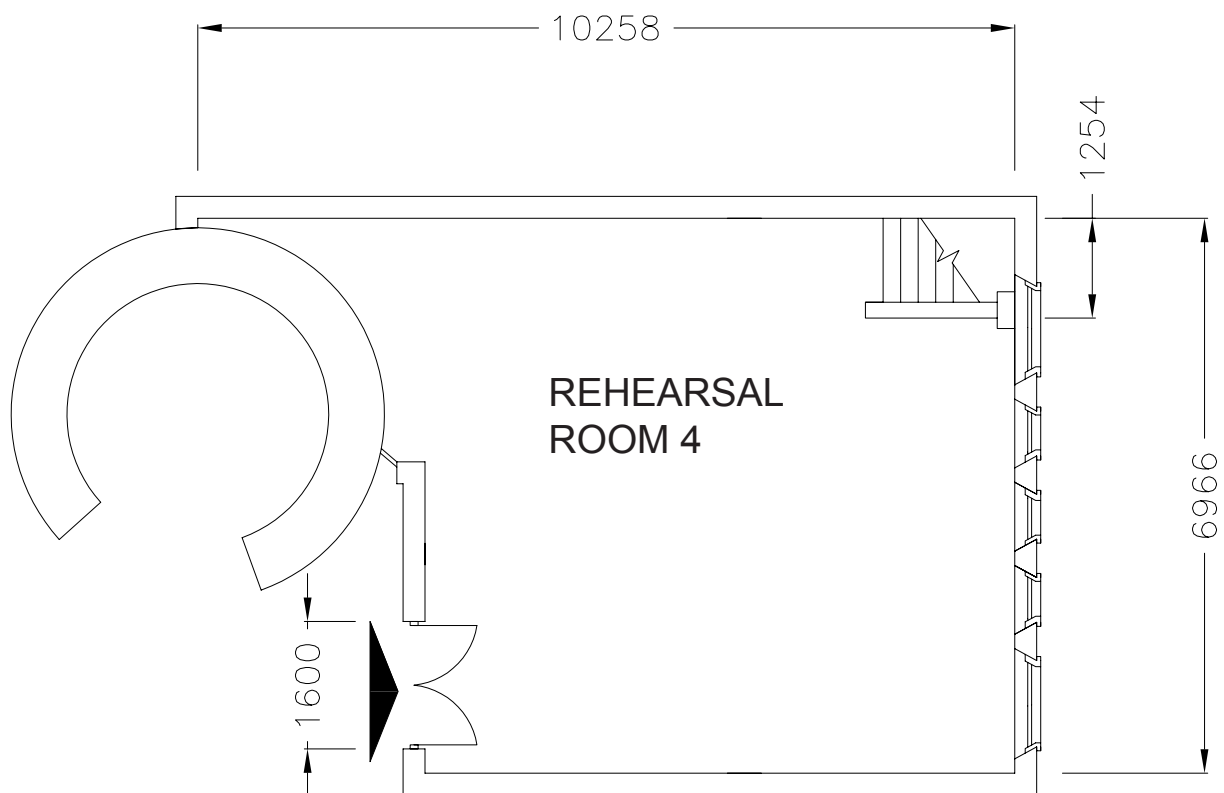

# Rehearsal Room 4



## KEY

	MAIN ENTRANCE
FE	FIRE EXIT
EP	ELECTRIC PANEL
WS	WATER SUPPLY OR SINK
H	HEATER

## REHEARSAL ROOM DIMENSIONS

REHEARSAL ROOM 4	LENGTH	WIDTH	HEIGHT	AREA
Feet/inches	33'6"	22'8"	10'2"	587.7 sq ft
Metres	10.26m	6.90m	3.11m	54.6 sq m

Dimensions are not to be scaled from this drawing. Production must verify all dimensions before commencing any works on this stage.

# Rehearsal Room 4

## Technical details

REHEARSAL ROOM SIZE	Length	33' 6" ft	10.26 m
	Width	22'8"	6.90 m
	Height (to runway beams)	10'2" ft	3.11 m
	Area	587.7 sq ft	54.6 sq m
ELECTRICAL SUPPLY	Maximum electrical load	32 amps	
	Number of 32 Amp sockets	0	
	Number of 13 Amp sockets	4 double	
BEAM LOADING	Maximum centre point loading	N/A	
	Maximum UDL loading	N/A	
	Number of roof beams	N/A	
WALL ANCHOR POINTS	N/A		
LOADING ACCESS	Double doors		
FLOOR TYPE	Wooden, raised floor		
FLOOR LOADING	Limited to 175kgs/m2		
HEATING	Wall Mounted Heaters	2	
WATER SUPPLY	No		
TELECOMS	Available	Yes	
	Number of comms. outlets	2	
	Broadband connectivity available	Yes	
FIRE PROTECTION	Sprinkler activation temperature	N/A	
	Smoke detectors	Yes	
FIRE EXTINGUISHERS	H2O	0	
	CO2	0	
	Foam	0	
RED LIGHT AND BELL	No		
EXTRACTION	No		

