

Rehearsal Room 5

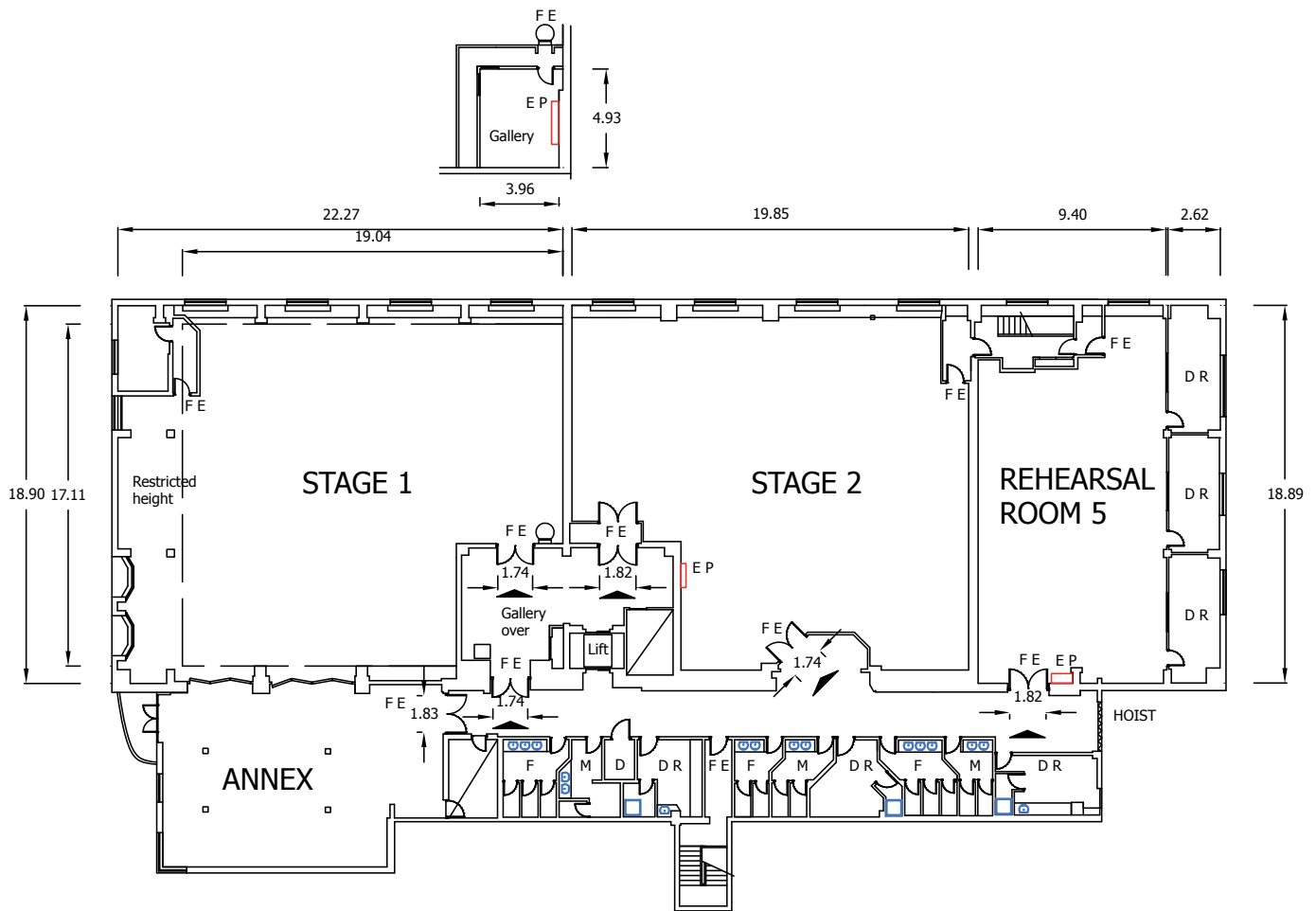

KEY

	MAIN ENTRANCE
FE	FIRE EXIT
EP	ELECTRIC PANEL
WS	WATER SUPPLY
H	HEATER
DR	DRESSING ROOM
M	MALE TOILET
F	FEMALE TOILET
D	DISABLED TOILET
O	OFFICE
SR	STORE ROOM

REHEARSAL ROOM DIMENSIONS

REHEARSAL ROOM 5	LENGTH	WIDTH	HEIGHT	AREA
Feet/inches	62' 0"	30' 10"	16' 5"	1,693.93 sq ft
Metres	18.89m	9.40m	5.00m	157.37 sq m

Dimensions are not to be scaled from this drawing. Production must verify all dimensions before commencing any works on this stage.

Rehearsal Room 5

Technical details

REHEARSAL ROOM SIZE	Length Width Height (to runway beams) Area	62' 0" 30' 10" 16' 5" 1,693.93 sq ft	18.89 m 9.40 m 5.00 m 157.37 sq m
ELECTRICAL SUPPLY	Maximum electrical load Number of 32 Amp sockets Number of 13 Amp sockets Powerlock 200 Amp	300 amps 0 14 double 1	
BEAM LOADING	Maximum UDL loading *maximum total distributed load across the length of steel pair of channels	1000kgs	
WALL ANCHOR POINTS	N/A		
LOADING ACCESS	Double doors via external hoist		
FLOOR TYPE	Wooden, raised floor		
FLOOR LOADING	Limited to 175kgs/m2		
HEATING	Wall Mounted Heaters	9	
WATER SUPPLY	No		
TELECOMS	Available Number of comms. outlets Broadband connectivity available	Yes 8 Yes	
FIRE PROTECTION	Sprinkler activation temperature Smoke detectors	N/A Yes	
FIRE EXTINGUISHERS	H2O CO2 Foam	0 1 1	
RED LIGHT AND BELL	No		
EXTRACTION	No		

