

Stage 1

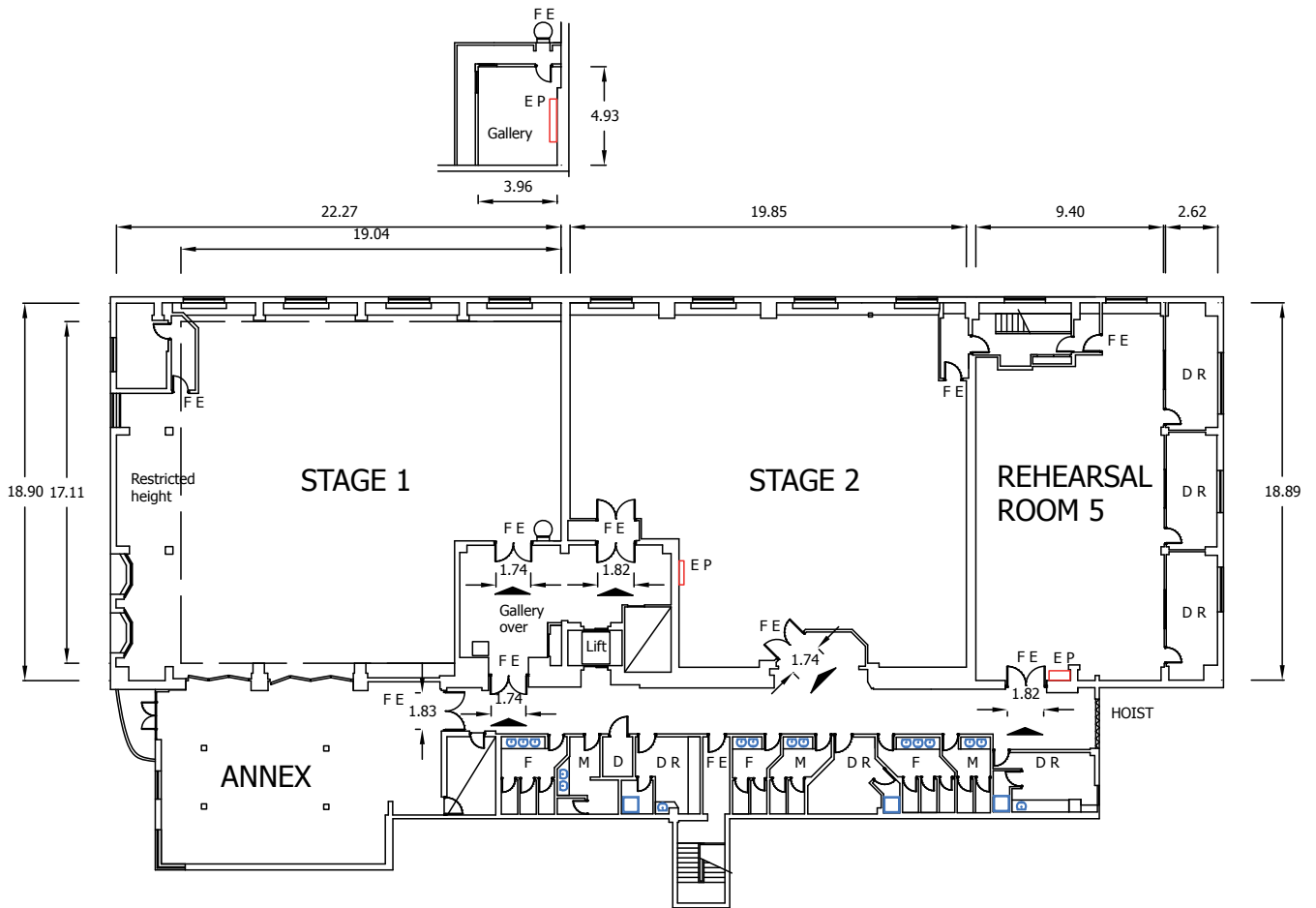

KEY

	MAIN ENTRANCE
FE	FIRE EXIT
EP	ELECTRIC PANEL
WS	WATER SUPPLY
H	HEATER
DR	DRESSING ROOM
M	MALE TOILET
F	FEMALE TOILET
D	DISABLED TOILET
O	OFFICE
SR	STORE ROOM

STAGE DIMENSIONS

STAGE 1	LENGTH	WIDTH	HEIGHT	AREA
Feet/inches	73' 1"	62' 0"	16' 5"	3,945 sq ft
Metres	22.27 m	18.90 m	5.00 m	366.35 sq m

Dimensions are not to be scaled from this drawing. Production must verify all dimensions before commencing any works on this stage.

Stage 1

Technical details

STAGE SIZE	Length	73' 1"	22.27 m
	Width	62' 0"	18.90 m
	Height (to runway beams)	16' 5"	5.00 m
	Area	3,945 sq ft	366.35 sq m
ELECTRICAL SUPPLY	Maximum electrical load	AC full load Amps 400 3-phase <i>Connection via sequential NRG Powerlock</i>	
	Number of 13 Amp sockets	20	
BEAM LOADING	3 x beams For more information contact the Operations Manager on 020 7363 3336		
WALL ANCHOR POINTS	N/A		
LOADING ACCESS	3rd floor Rooftop via goods hoist		
FLOOR TYPE	Wooden		
FLOOR LOADING	N/A		
HEATING	Radiators	Yes	
WATER ON STAGE	No		
TELECOMS & BROADBAND	Available	Yes	
	Number of communications outlets	4	
	Broadband connectivity available	Yes	
FIRE PROTECTION	Sprinkler activation temperature	N/A	
	Smoke detectors	Yes	
FIRE EXTINGUISHERS	H2O	0	
	CO2	1	
	Foam	1	
RED LIGHT AND BELL	Yes, next to entrance		
EXTRACTION	No		

