

Stage 11

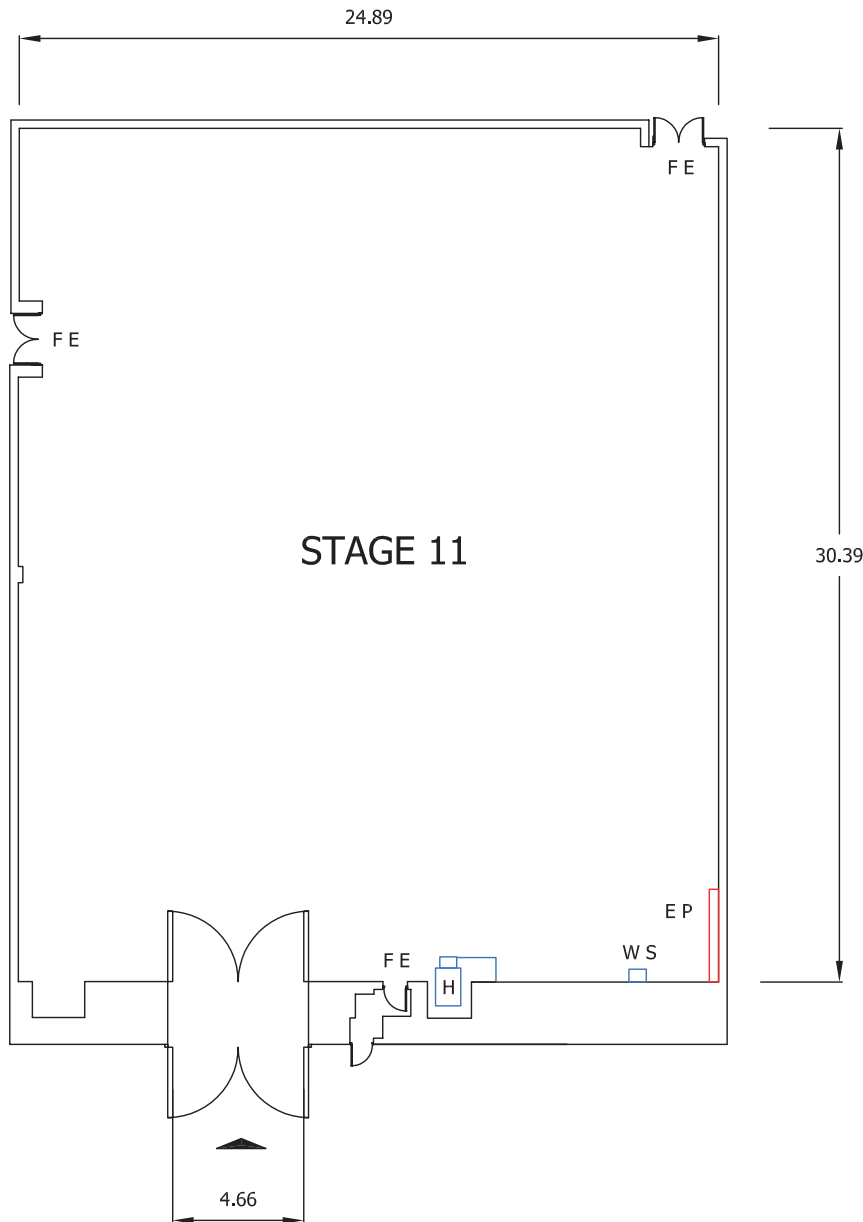

KEY

	MAIN ENTRANCE
FE	FIRE EXIT
EP	ELECTRIC PANEL
WS	WATER SUPPLY OR SINK
H	HEATER

STAGE DIMENSIONS

STAGE 11	LENGTH	WIDTH	HEIGHT	AREA
Feet/inches	99'8"	81'8"	30'2"	8,128 sq ft
Metres	30.39m	24.89m	9.19m	755.09 sq m

Dimensions are not to be scaled from this drawing. Production must verify all dimensions before commencing any works on this stage.

Stage 11

Technical details

STAGE SIZE	Length	99' 8"	30.39 m
	Width	81' 8"	24.89 m
	Height (to runway beams)	30' 2"	9.19 m
	Area	8,128 sq ft	755.09 sq m
ELECTRICAL SUPPLY	Maximum electrical load	AC full load Amps 400 3-phase <i>Connection via sequential NRG Powerlock</i>	
	Number of 63 Amp sockets	1	
	Number of 32 Amp sockets	1	
	Number of 16 Amp sockets	1	
	Number of 13 Amp sockets	16	
BEAM LOADING	1 Tonne evenly distributed, per beam. 13 x beams.		
WALL ANCHOR POINTS	N/A		
LOADING ACCESS	Dock doors		
FLOOR TYPE	Concrete		
FLOOR LOADING	N/A		
HEATING	Heated air blower	Yes	
WATER ON STAGE	Yes		
TELECOMS & BROADBAND	Available		
FIRE PROTECTION	Sprinkler activation temperature	141C	
	Smoke detectors	No	
FIRE EXTINGUISHERS	H2O	0	
	CO2	3	
	Foam	3	
RED LIGHT AND BELL	Yes, next to entrance		
EXTRACTION	No		

