

# Stage 2

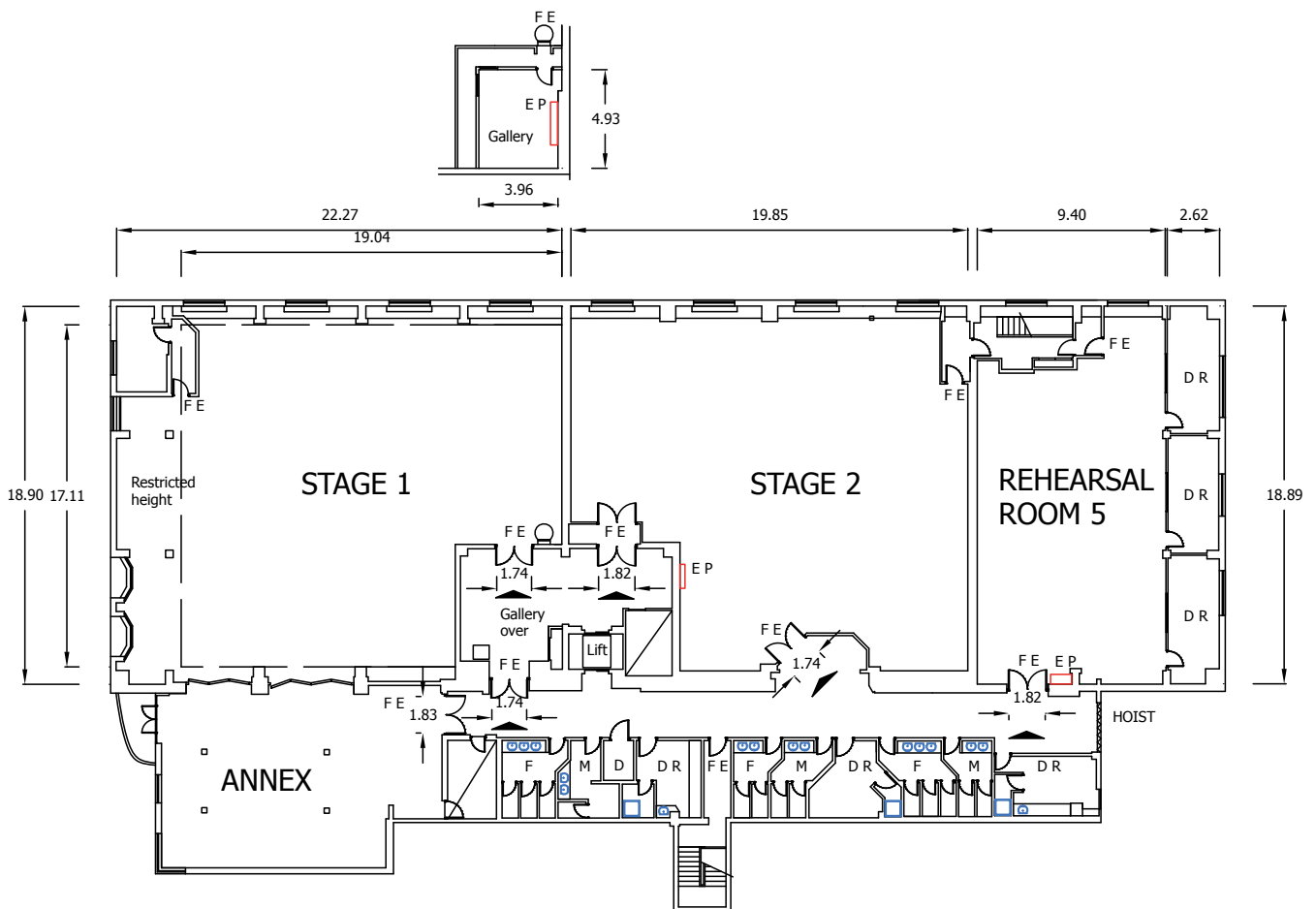

## KEY

	MAIN ENTRANCE
FE	FIRE EXIT
EP	ELECTRIC PANEL
WS	WATER SUPPLY
H	HEATER
DR	DRESSING ROOM
M	MALE TOILET
F	FEMALE TOILET
D	DISABLED TOILET
O	OFFICE
SR	STORE ROOM

## STAGE DIMENSIONS

STAGE 2	LENGTH	WIDTH	HEIGHT	AREA
Feet/inches	65'1"	57'11"	16' 5"	3,219 sq ft
Metres	19.85m	17.64m	5.00m	299.07 sq m

Dimensions are not to be scaled from this drawing. Production must verify all dimensions before commencing any works on this stage.

# Stage 2

## Technical details

STAGE SIZE	Length	65' 1"	19.85 m
	Width	57' 11"	17.64 m
	Height (to runway beams)	16' 5"	5.00 m
	Area	3,219 sq ft	299.07 sq m
ELECTRICAL SUPPLY	Maximum electrical load	AC full load Amps 400 3-phase Connection via sequential NRG Powerlock x37	
	Number of 13 Amp sockets		
BEAM LOADING	3 x beams. For more information contact the Operations Manager on 020 7363 3336		
WALL ANCHOR POINTS	N/A		
LOADING ACCESS	3rd floor Rooftop via goods hoist		
FLOOR TYPE	Wooden		
FLOOR LOADING	N/A		
HEATING	Radiators	Yes	
WATER ON STAGE	No		
TELECOMS & BROADBAND	Available		
FIRE PROTECTION	Sprinkler activation temperature	N/A	
	Smoke detectors	Yes	
FIRE EXTINGUISHERS	H2O	0	
	CO2	2	
	Foam	2	
RED LIGHT AND BELL	Yes, next to entrance		
EXTRACTION	No		

