

Stage 11

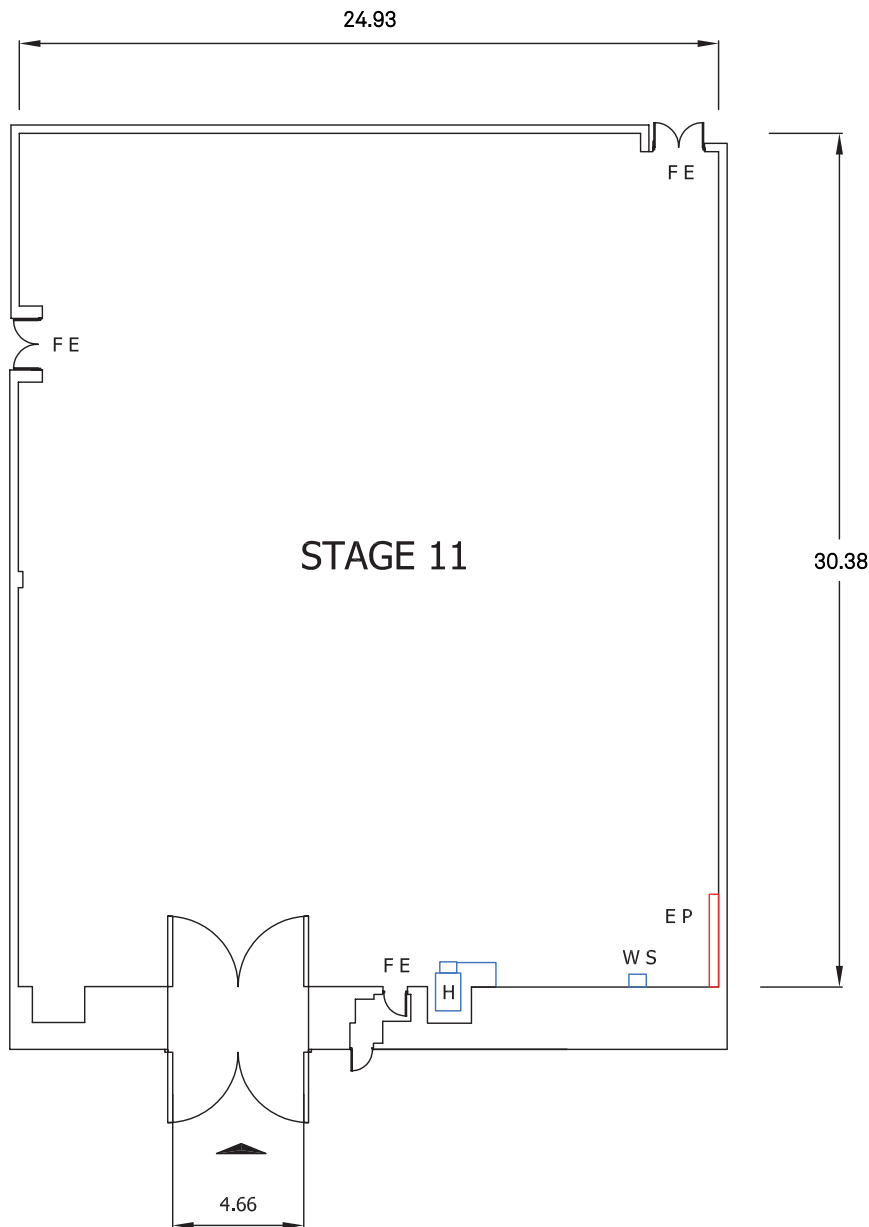

KEY

| | |
|----|----------------------|
| | MAIN ENTRANCE |
| FE | FIRE EXIT |
| EP | ELECTRIC PANEL |
| WS | WATER SUPPLY OR SINK |
| H | HEATER |

STAGE DIMENSIONS

| STAGE 11 | LENGTH | WIDTH | HEIGHT | AREA |
|-------------|--------|--------|--------|-------------|
| Feet/inches | 99'7" | 81'8" | 30'2" | 8,114 sq ft |
| Metres | 30.38m | 24.93m | 9.19m | 753.80 sq m |

Dimensions are not to be scaled from this drawing. Production must verify all dimensions before commencing any works on this stage.

Stage 11

Technical details

| | | | |
|----------------------|---|--|-------------|
| STAGE SIZE | Length | 99' 7" | 30.38 m |
| | Width | 81' 8" | 24.93 m |
| | Height (to runway beams) | 30' 2" | 9.19 m |
| | Area | 8,114 sq ft | 753.80 sq m |
| ELECTRICAL SUPPLY | Maximum electrical load | AC full load Amps 400 3-phase Connection via sequential NRG | |
| | Number of 63 Amp sockets | Powerlock x1 5 pin | |
| | Number of 32 Amp sockets | x2 3 pin | |
| | Number of 16 Amp sockets | x2 | |
| | Number of 13 Amp sockets | x13 | |
| BEAM LOADING | 1 Tonne evenly distributed, per beam. 13 x beams. | | |
| WALL ANCHOR POINTS | N/A | | |
| LOADING ACCESS | Dock doors | Width | 4.66m |
| | | Height | 5.68m |
| FLOOR TYPE | Concrete | | |
| FLOOR LOADING | N/A | | |
| HEATING | Heated air blower | Yes | |
| WATER ON STAGE | Yes | | |
| TELECOMS & BROADBAND | Available | | |
| FIRE PROTECTION | Sprinkler activation temperature | 141C | |
| | Smoke detectors | No | |
| FIRE EXTINGUISHERS | H2O | 0 | |
| | CO2 | 3 | |
| | Foam | 3 | |
| RED LIGHT AND BELL | Yes, next to entrance | | |
| EXTRACTION | No | | |

