

# Stage 9

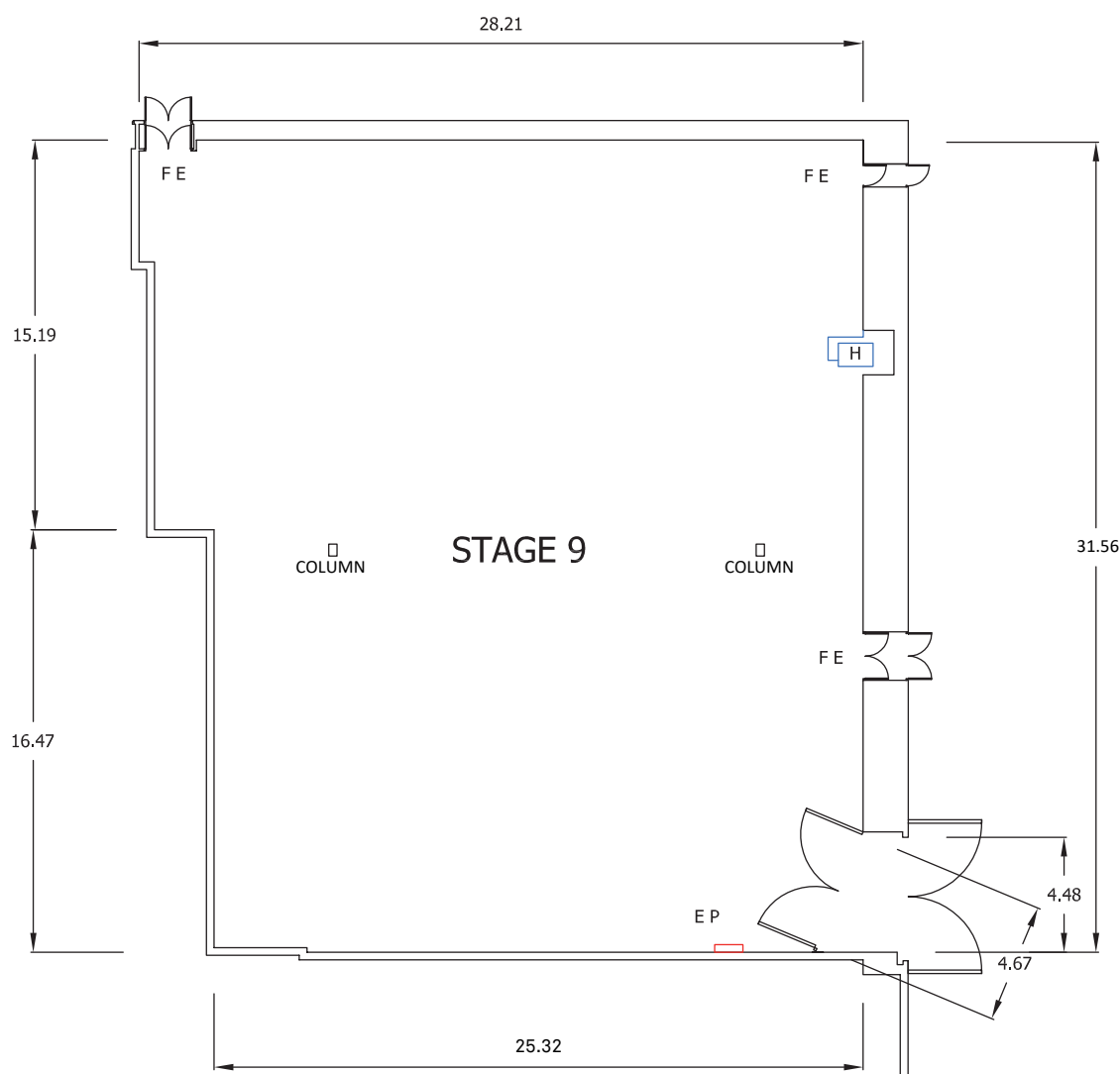

## KEY

	MAIN ENTRANCE
FE	FIRE EXIT
EP	ELECTRIC PANEL
WS	WATER SUPPLY OR SINK
H	HEATER

## STAGE DIMENSIONS

STAGE 9	LENGTH	WIDTH	HEIGHT	AREA
Feet/inches	103'6"	83'08"	33'0"	8,925 sq ft
Metres	31.56m	25.32m	10.06m	829.20 sq m

Dimensions are not to be scaled from this drawing. Production must verify all dimensions before commencing any works on this stage.

# Stage 9

## Technical details

STAGE SIZE	Length	103' 6"	31.56 m
	Width	83' 08"	25.32 m
	Height (to runway beams)	33' 0"	10.06 m
	Area	8,925 sq ft	829.20 sq m
ELECTRICAL SUPPLY	Maximum electrical load	AC full load Amps 400 3-phase <i>Connection via sequential NRG Powerlock</i>	
	Number of 16 Amp sockets	x2	
	Number of 13 Amp sockets	x16	
BEAM LOADING	1 Tonne evenly distributed, per beam. 5 x beams.		
WALL ANCHOR POINTS	N/A		
LOADING ACCESS	Dock doors	Width Height	4.48m 5.01m
FLOOR TYPE	Concrete		
FLOOR LOADING	N/A		
HEATING	Heated air blower	Yes	
WATER ON STAGE	No		
TELECOMS & BROADBAND	Available		
FIRE PROTECTION	Sprinkler activation temperature	68C	
	Smoke detectors	No	
FIRE EXTINGUISHERS	H2O	0	
	CO2	3	
	Foam	4	
RED LIGHT AND BELL	Yes, next to entrance		
EXTRACTION	No		

